

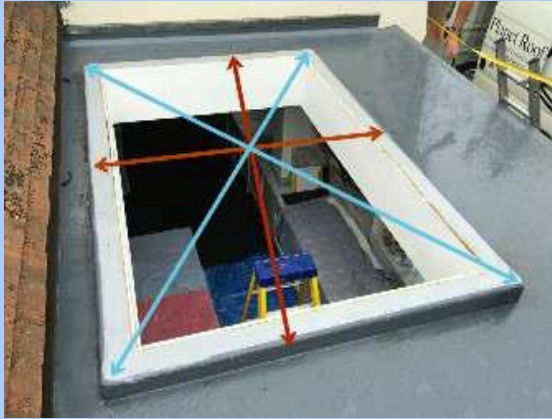

Installation Guide Garrard MaxiLite

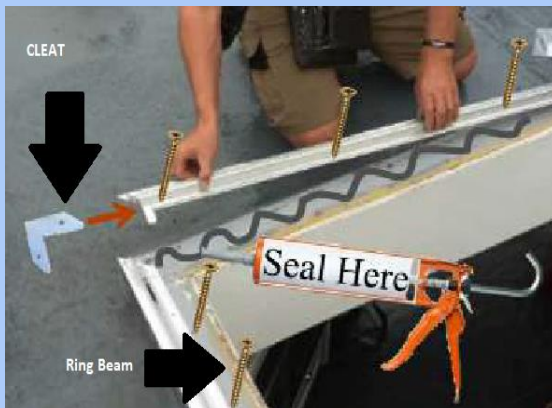

1. Check sizes and that the opening is square



2. Join ring beam sections, seal and screw to opening



3. Slide hip rafters on to ridge ends



4. Fix hip with M6x25 PAN head bolts, seal any gaps



9. Push expanding foam strips in gaps on radius



10. Apply adhesive cover to radius, covering foam seals

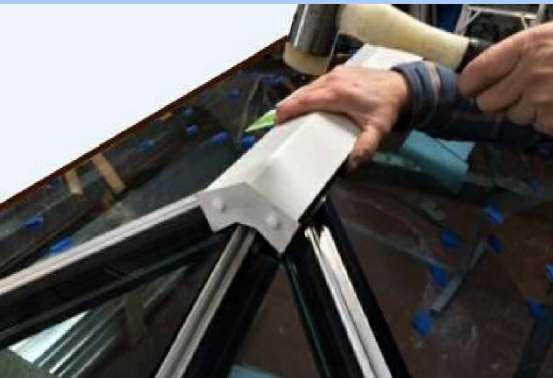

11. Fit Ridge top cap first BEFORE rafter top caps



12. Tap rafter caps down on TOP of ridge cap gasket

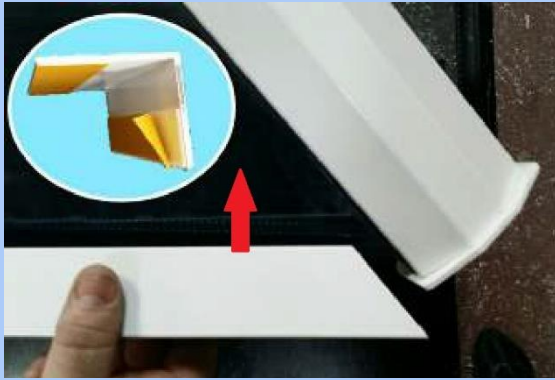

13. Locate glass end trim & peel back tape



14. Position so glass end trim fits to edge of rafter

Parts Identification



Ring Beam



Rafter/hip top cap

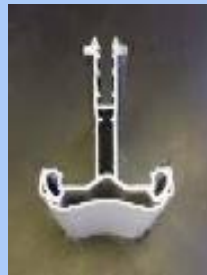

Rafter/hip



Ridge top cap



Ridge



Expanding foam radius gap filler



Butyl tape pad for radius end



Aluminium bottom edge trim



Rafter end plate and cap covers



Rafter end rubber and glass protector

Tools you will need



Glazing paddle



Rubber Mallet



Silicone Gun



Phillips Screw Driver



10mm spanner



8mm Spanner

Fixings supplied



50mm Screws for Fixing ring beam to Frame with black Pop cover



30mm Hex screws for rafter end plates



Hex head push caps for rafter end plate screws



M6x22mm Pan head bolts for fixing rafters to ring beam



M6x25mm Hex Head bolts for fixing Rafters to ring beam



M6 Nuts for ridge rafters